

TIP PROJECT: NA

STATE OF NORTH CAROLINA
DIVISION OF HIGHWAYS

PLAN FOR PROPOSED
CULVERT REPLACEMENT

**SOUTH STOKES SCHOOL ROAD
STOKES COUNTY**

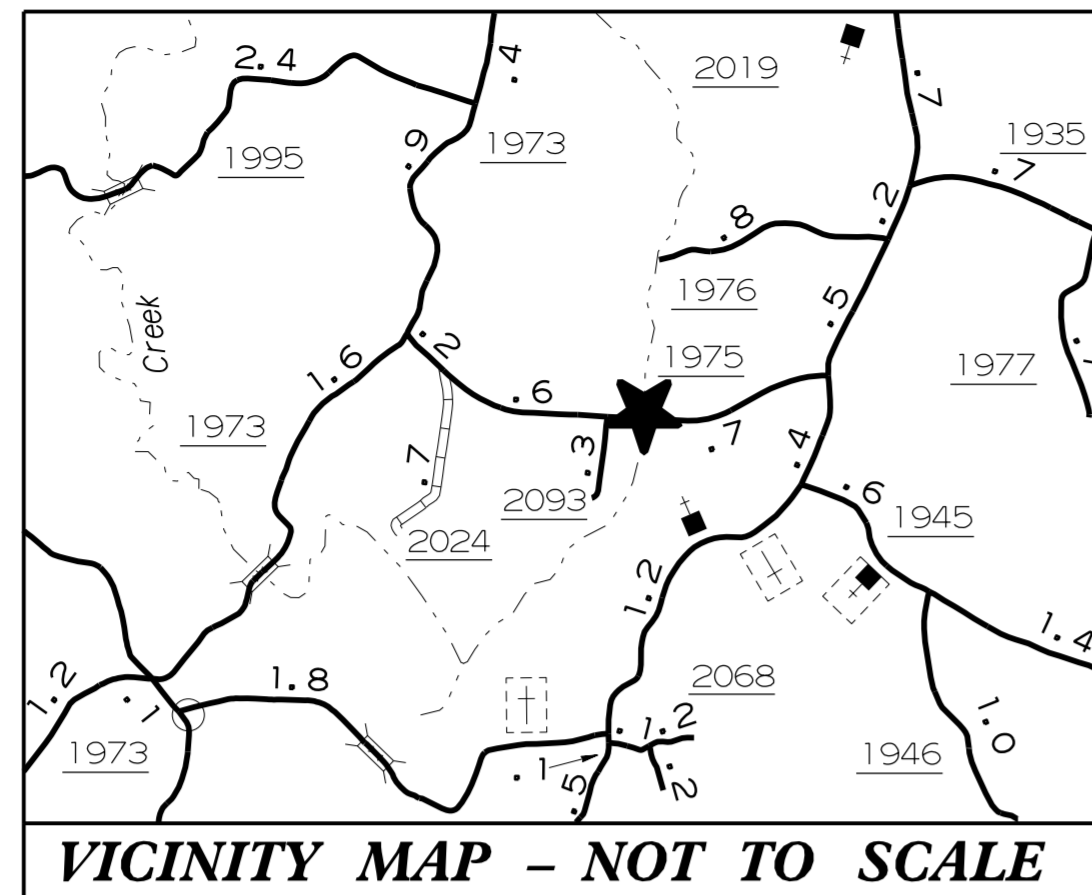

VICINITY MAP - NOT TO SCALE

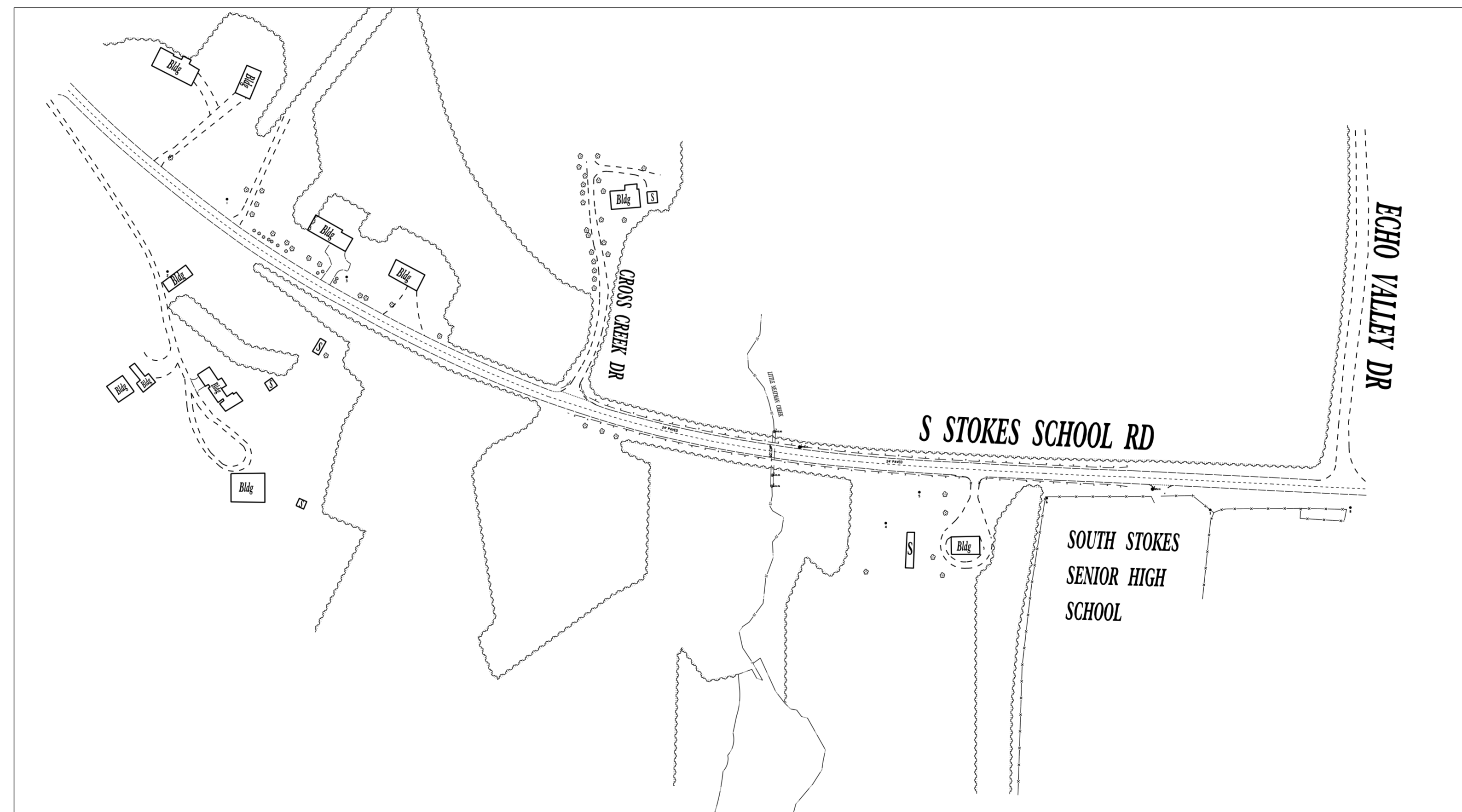

STATE	STATE PROJECT REFERENCE NO.	SHEET NO.	TOTAL SHEETS
N.C.	SOUTH STOKES SCHOOL RD.	1	3
STATE PROJ. NO.	F.A. PROJ. NO.	DESCRIPTION	

**DOCUMENT NOT CONSIDERED FINAL
UNLESS ALL SIGNATURES COMPLETED**

GRAPHIC SCALE



PLANS

ROADSIDE ENVIRONMENTAL UNIT
DIVISION OF HIGHWAYS
STATE OF NORTH CAROLINA

THESE PLANS COMPLY WITH THE REGULATIONS SET FORTH BY THE
NCG-010000 GENERAL CONSTRUCTION PERMIT EFFECTIVE AUGUST 3, 2011
ISSUED BY THE NORTH CAROLINA DEPARTMENT OF ENVIRONMENT AND
NATURAL RESOURCES DIVISION OF WATER QUALITY.

Prepared in the Office of:
DIVISION 9 DDC
375 Silas Creek Parkway
Winston-Salem, NC 27127

2018 STANDARD SPECIFICATIONS

Designed by:

Scott A. Jones

4058

NAME

LEVEL III CERTIFICATION NO.

Roadway Standard Drawings

The following roadway english standards as appear in "Roadway Standard Drawings"- Roadway Design Unit - N. C. Department of Transportation - Raleigh, N. C., dated January 2018 and the latest revision thereto are applicable to this project and by reference hereby are considered a part of these plans.

- | | |
|--|--|
| 1604.01 Railroad Erosion Control Detail | 1632.01 Rock Inlet Sediment Trap Type A |
| 1605.01 Temporary Silt Fence | 1632.02 Rock Inlet Sediment Trap Type J |
| 1606.01 Special Sediment Control Fence | 1632.03 Rock Inlet Sediment Trap Type C |
| 1607.01 Gravel Construction Entrance | 1633.01 Temporary Rock Silt Check Type A |
| 1622.01 Temporary Jerms and Slope Drains | 1633.02 Temporary Rock Silt Check Type J |
| 1630.01 Riser Basin | 1634.01 Temporary Rock Sediment Dam Type A |
| 1630.02 Silt Basin Type J | 1634.02 Temporary Rock Sediment Dam Type J |
| 1630.03 Temporary Silt Ditch | 1635.01 Rock Pipe Inlet Sediment Trap Type A |
| 1630.04 Stilling Basin | 1635.02 Rock Pipe Inlet Sediment Trap Type J |
| 1630.05 Temporary Diversion | 1640.01 Coir Fiber Jaffle |
| 1630.06 Special Stilling Basin | 1645.01 Temporary Stream Crossing |
| 1631.01 Matting Installation | |

DIVISION OF HIGHWAYS
STATE OF NORTH CAROLINA

PROJECT REFERENCE NO.	SHEET NO.
SOUTH STOKES SCHOOL RD.	2
ROADWAY DESIGN ENGINEER	HYDRAULICS ENGINEER

SOIL STABILIZATION TIMEFRAMES

<i>SITE DESCRIPTION</i>	<i>STABILIZATION TIME</i>	<i>TIMEFRAME EXCEPTIONS</i>
PERIMETER DIKES, SWALES, DITCHES AND SLOPES	7 DAYS	NONE
HIGH QUALITY WATER (HQW) ZONES	7 DAYS	NONE
SLOPES STEEPER THAN 3:1	7 DAYS	IF SLOPES ARE 10' OR LESS IN LENGTH AND ARE NOT STEEPER THAN 2:1, 14 DAYS ARE ALLOWED.
SLOPES 3:1 OR FLATTER	14 DAYS	7 DAYS FOR SLOPES GREATER THAN 50' IN LENGTH.
ALL OTHER AREAS WITH SLOPES FLATTER THAN 4:1	14 DAYS	NONE, EXCEPT FOR PERIMETERS AND HQW ZONES.

REVISIONS

NOTES: STAGE ALL WORK SO THAT NCDOT BMP'S ARE ADHERED TO DURING REMOVAL OF EXISTING STRUCTURE AND INSTALLATION OF THE NEW STRUCTURE. USE EXTRA MEASURE TO ENSURE THAT ERODING SOILS ARE NOT AN ISSUE.

NOTES: IT IS REQUIRED THAT ALL WORK WITHIN THE STREAM BE COMPLETED IN DRY CONDITIONS. WATER SHALL BE PUMPED AROUND THE PROJECT SITE AND ALLOWED TO SHEET FLOW THROUGH VEGETATION OR BE FILTERED THROUGH AN APPROVED SILT BAG. GIVEN THE FACT THAT WATER WILL FLOW THROUGH THE PROJECT DURING EVENING HOURS, ANY EXPOSED DIRT SHOULD BE COVERED WITH FILTER FABRIC OR PLASTIC SHEETING PRIOR TO LEAVING THE PROJECT.

Environmentally Sensitive Areas:
 This project is located in an "Environmentally Sensitive Area." This designation requires special procedures to be used for clearing and grubbing, temporary stream crossings, and grading operations within the area identified on the plans. This also requires special procedures to be used for seeding and mulching and staged seeding within the project.

Clearing and Grubbing:
 In areas identified on the erosion control plans as "Environmentally Sensitive Areas", the Contractor may perform clearing operations, but not grubbing operations until immediately prior to beginning grading operations as described in Section 200, Article 200-1, in the Standard Specifications. The "Environmentally Sensitive Area" shall be defined as a 50 foot buffer zone on both sides of the stream (or depression), measured from top of streambank, (or center of depression). Only clearing operations (not grubbing) shall be allowed in this buffer zone until immediately prior to beginning grading operations. Erosion control devices shall be installed immediately following the clearing operation.

Grading:
 Once grading operations begin in identified "Environmentally Sensitive Areas", work will progress in a continuous manner until complete. All construction within these areas must progress in a continuous manner such that each phase is complete and areas permanently stabilized prior to beginning of next phase. Failure on the part of the Contractor to complete any phase of construction in a continuous manner in "Environmentally Sensitive Areas" as specified will be just cause for the Engineer to direct the suspension of work in accordance with Section 108-7 of the Standard Specifications.

Temporary Stream Crossings:
 Any crossing of streams within the limits of this project must be accomplished in accordance with Section 107-13(b) of the Standard Specifications.

Seeding and Mulching:
 Seeding and mulching shall be performed in accordance with Section 1660 of the Standard Specifications and vegetative cover sufficient to restrain erosion shall be installed immediately following grade establishment.

Seeding and mulching shall be performed on the areas disturbed by construction immediately following final grade establishment. No appreciable time shall lapse into the contract time without stabilization of slopes, ditches and other areas within the "Environmentally Sensitive Areas" as indicated on the erosion control plans.

Stage Seeding:
 The work covered by this section shall consist of the establishment of a vegetative cover on cut and fill slopes as grading progresses. Seeding and mulching shall be done in stages on cut and fill slopes which are greater than 20 feet in height measured along the slope, or greater than 2 acres in area. Each stage shall not exceed the limits stated above.

All work described above will be paid for at the contract price for "Lump Sum for Erosion Control" established in the contract for the work involved. Additional payments will not be made for the requirements of this section as the cost for this work should be included in the contract price for "Lump Sum for Erosion Control" for the work involved.

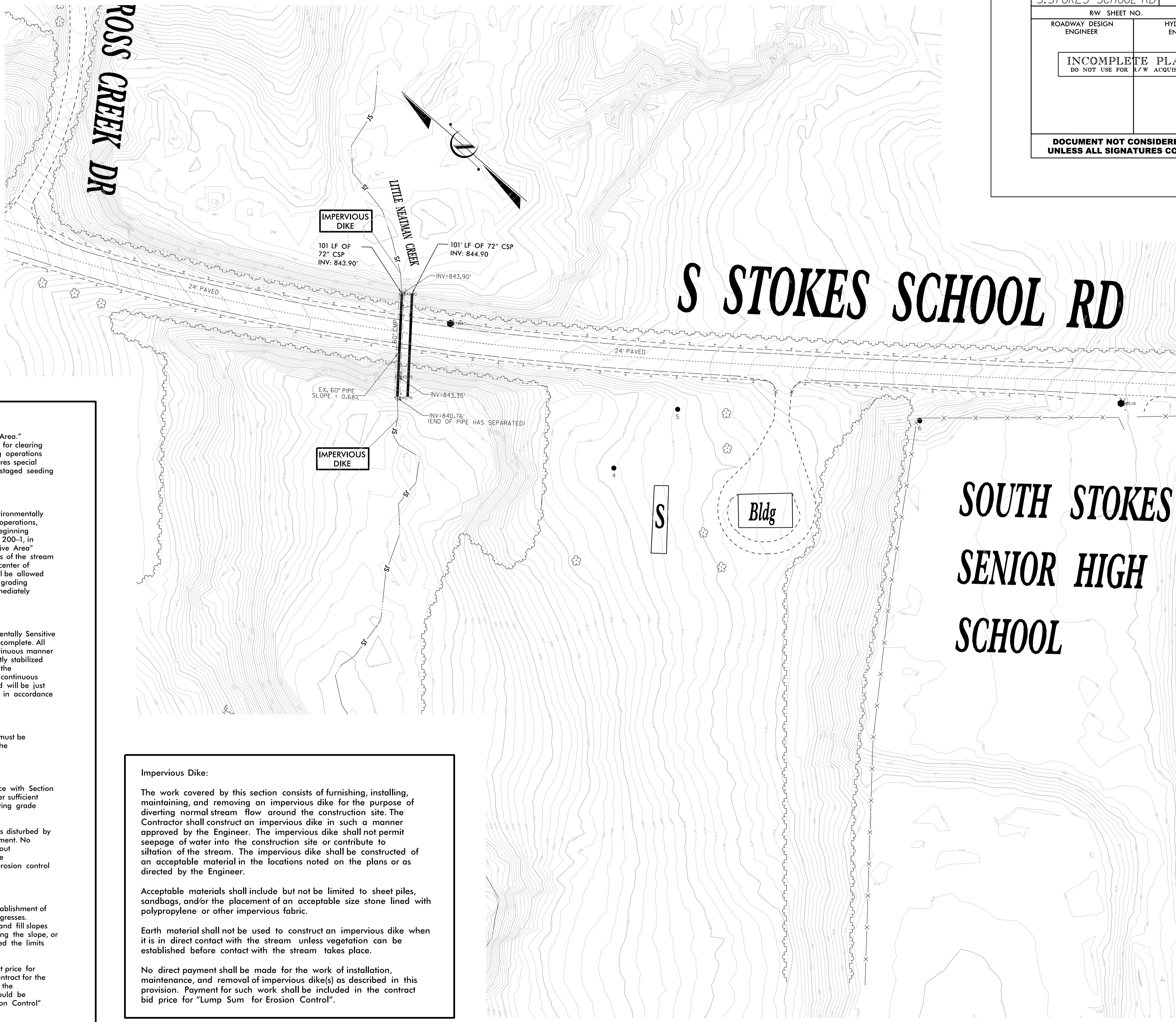

Impervious Dike:

The work covered by this section consists of furnishing, installing, maintaining, and removing an impervious dike for the purpose of diverting normal stream flow around the construction site. The Contractor shall construct an impervious dike in such a manner approved by the Engineer. The impervious dike shall not permit seepage of water into the construction site or contribute to siltation of the stream. The impervious dike shall be constructed of an acceptable material in the locations noted on the plans or as directed by the Engineer.

Acceptable materials shall include but not be limited to sheet piles, sandbags, and/or the placement of an acceptable size stone lined with polypropylene or other impervious fabric.

Earth material shall not be used to construct an impervious dike when it is in direct contact with the stream unless vegetation can be established before contact with the stream takes place.

No direct payment shall be made for the work of installation, maintenance, and removal of impervious dike(s) as described in this provision. Payment for such work shall be included in the contract bid price for "Lump Sum for Erosion Control".

PROJECT REFERENCE NO.	SHEET NO.
S. STOKES SCHOOL RD	3
RW SHEET NO. N/A	
ROADWAY DESIGN ENGINEER	HYDRAULICS ENGINEER
INCOMPLETE PLANS DO NOT USE FOR R/W ACQUISITION	
DOCUMENT NOT CONSIDERED FINAL UNLESS ALL SIGNATURES COMPLETED	